

**Off Road
& Car Styling**



Zubehörspezialist für Geländewagen

Pick-Up's & Suv's

Tel. 0 49 61 / 83 81 48 Fax: 0 49 61 / 83 81 49

info@Off-Road-Reuter.de

www.off-road-reuter.de

Montageanleitung
Hardtop für
VW Amarok Doppelkabiner

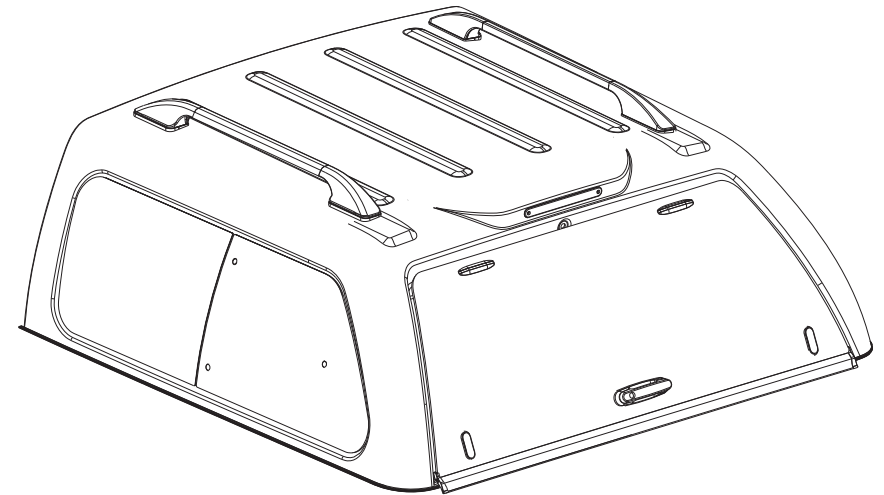

STYLISH

COMMERCIAL

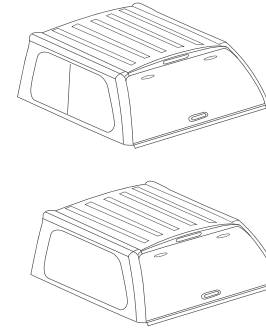
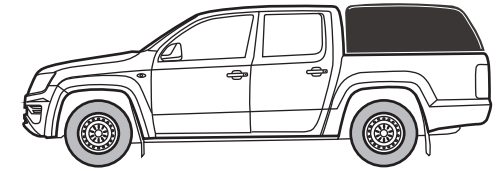
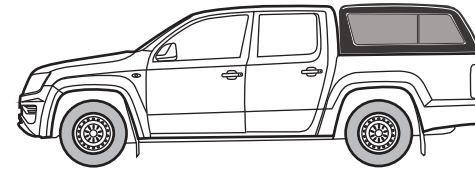

OPTION #

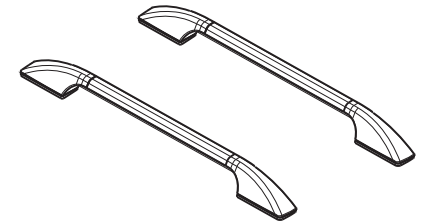

X1



X6



X6

(OPTIONAL FOR C-CLAMP COVER)



X1

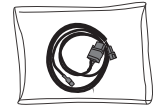

X1

(OPTIONAL FOR DEMISTER)



X3

50 mm.



No.10



No.5



Silicone

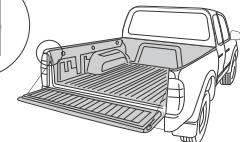
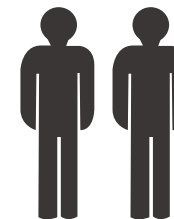

1

6

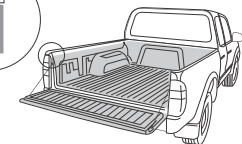

1

6

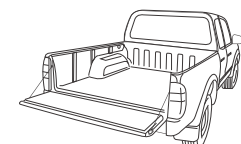

1

6

1.1

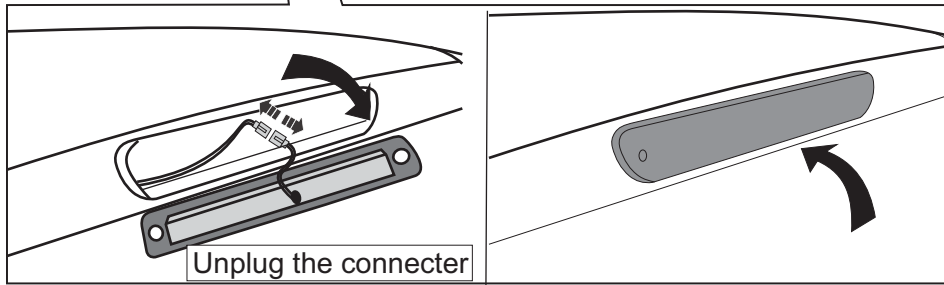
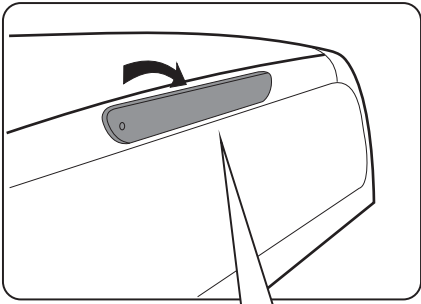

1.2

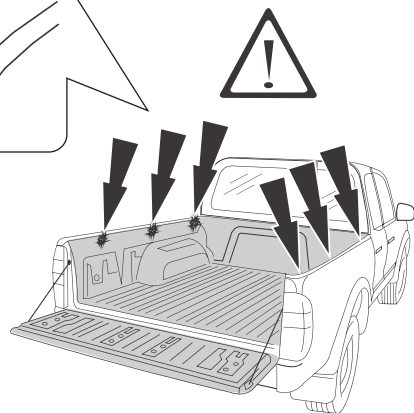
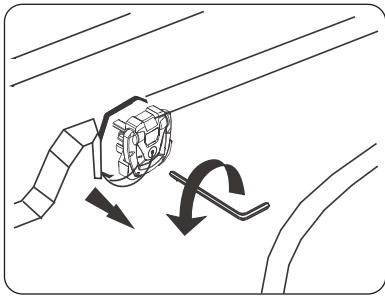

OPTION

6

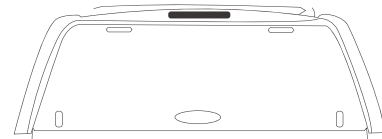
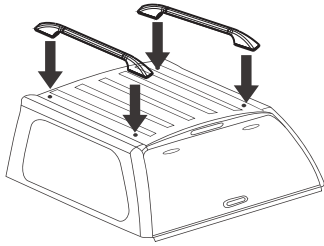

Max load 25 kg. (No Warranty)
Max speed 140 Km/hr (90 Miles/hr)

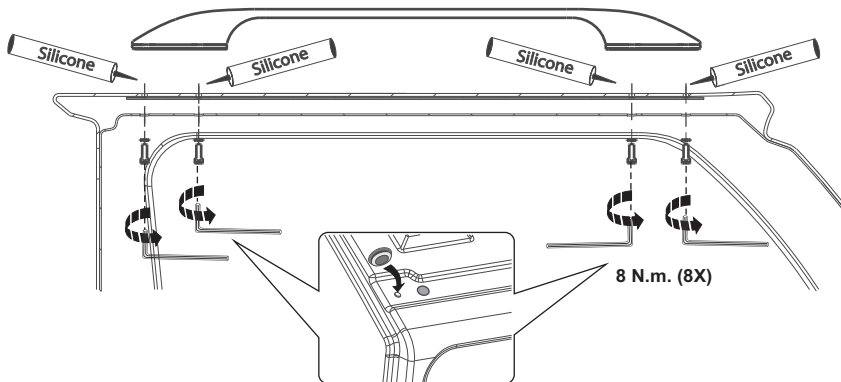
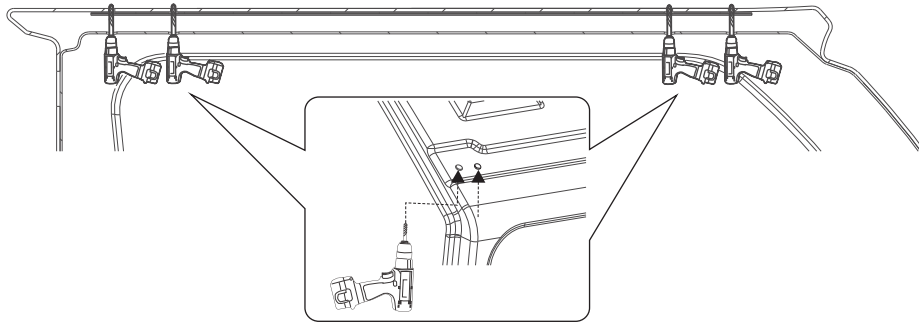
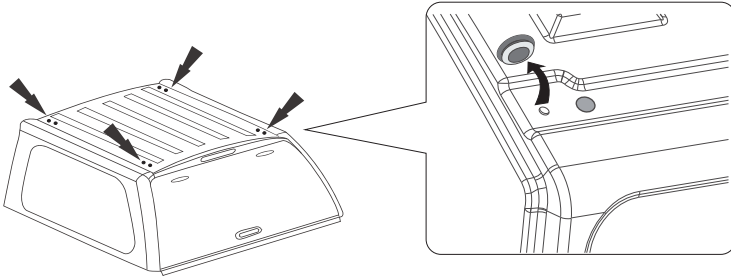

2

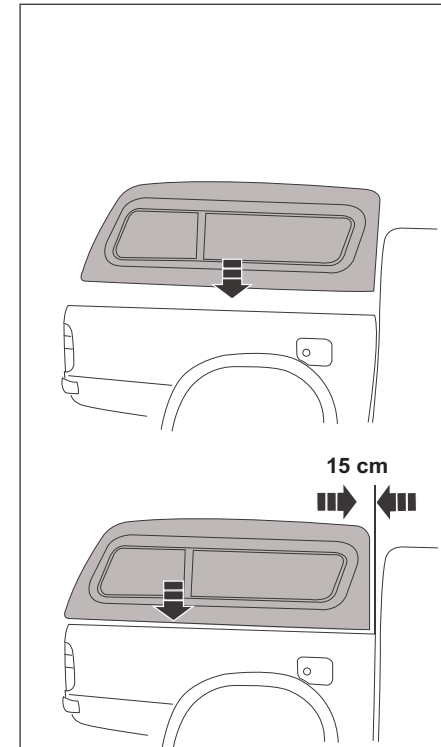
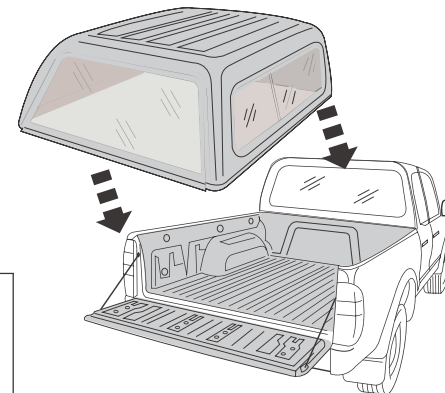
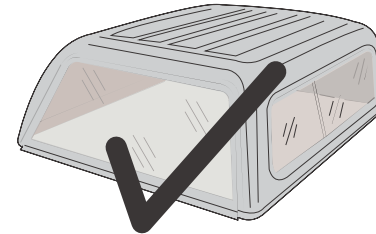
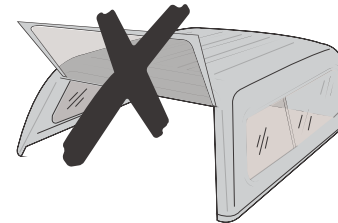
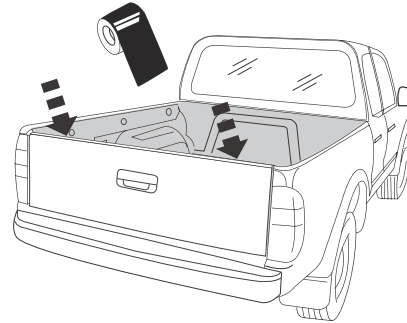

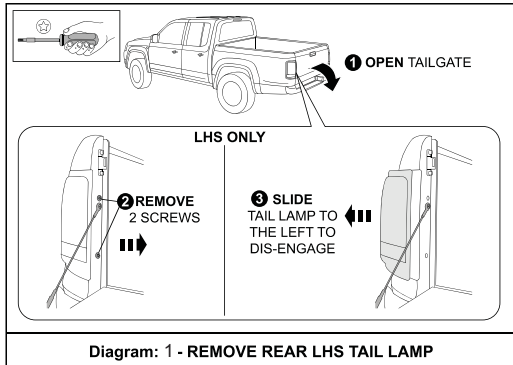

Open the tailgate. Remove and retain the two (2) screws from the left hand side as shown securing the left hand side tail lamp, using a T30 torx drive screwdriver. Remove the tail lamp by sliding it to the left to dis-engage it from the ball fixings. (ref. diagram 1).

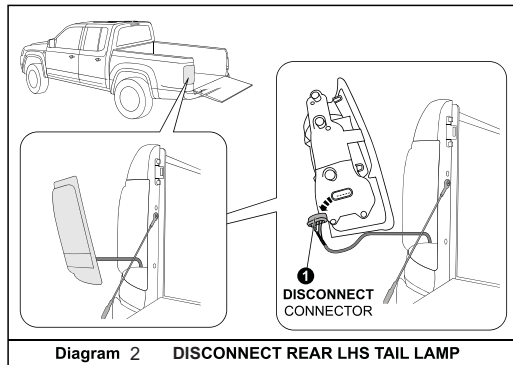

Disconnect the connector from the tail lamp (ref. diagram 2).

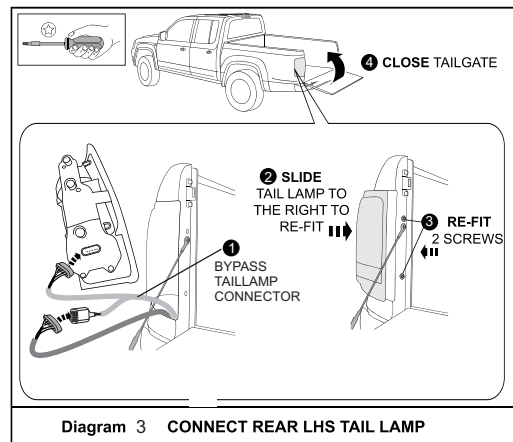

Insert bypass tail lamp connector between the connector and the tail lamp and re-fit tail lamp to the vehicle by locating it on the ball fixings and sliding the tail lamp to the right. Secure to the vehicle with the two (2) screws previously removed. Close the tailgate. (ref. diagram 3).

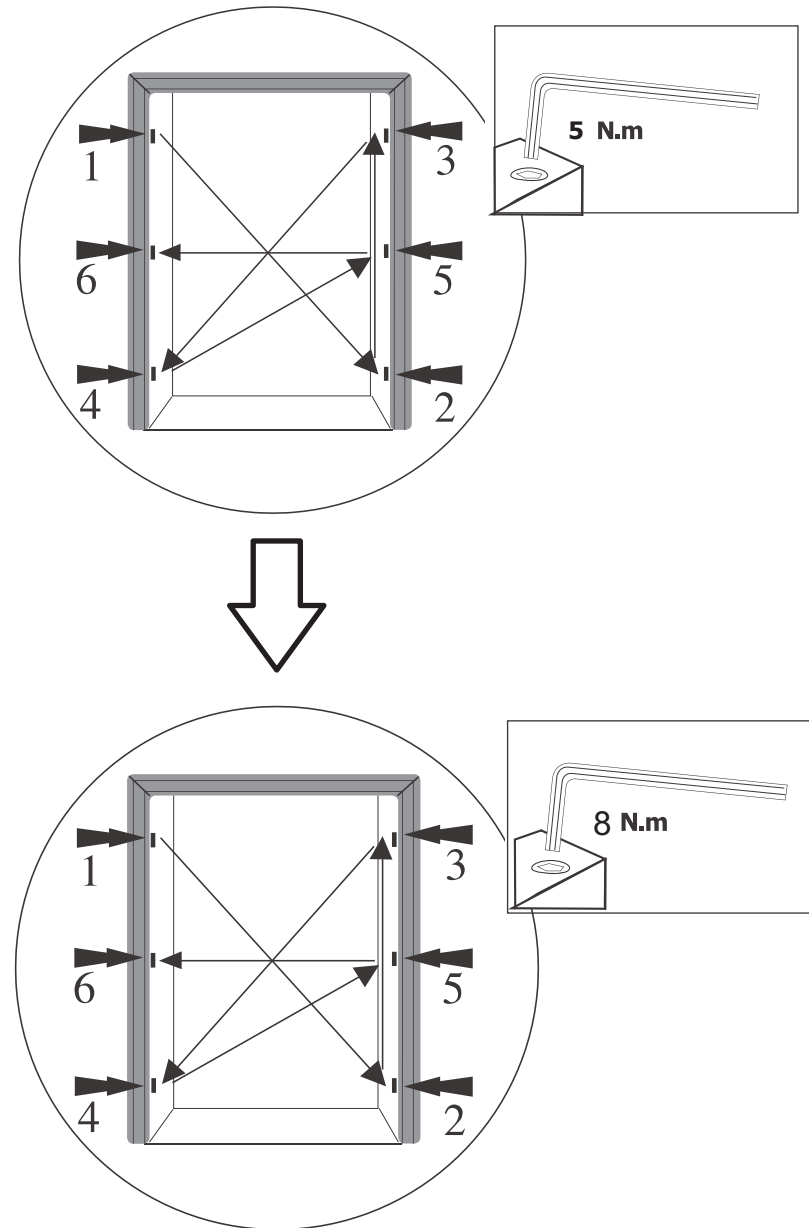

Note

- Apply LOCTITE 242/243 to the screws
- Re-tighten the screws 10 Nm every 1000 Km.

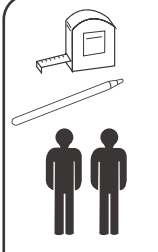

5

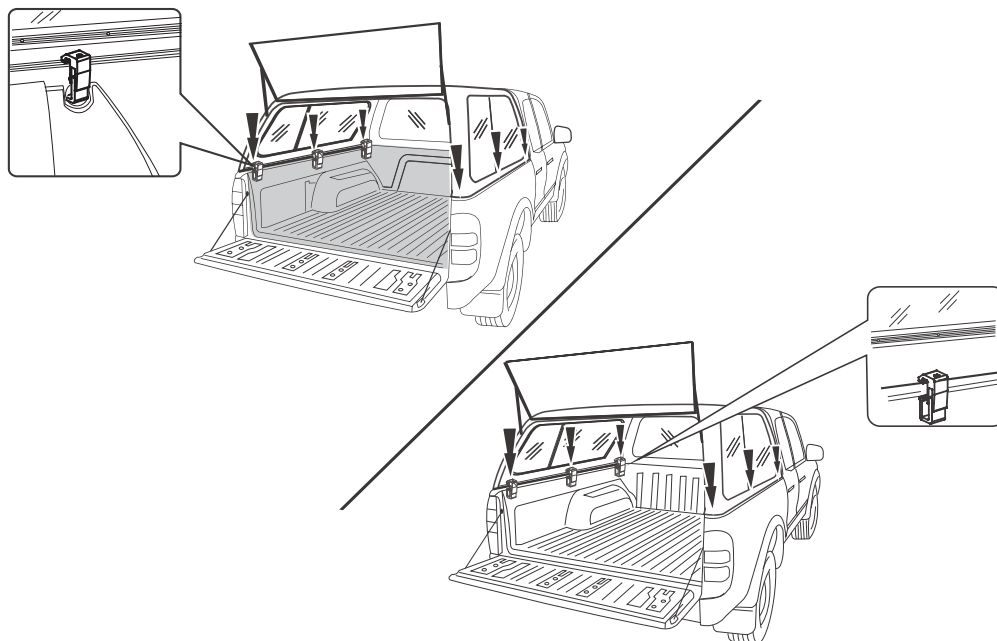
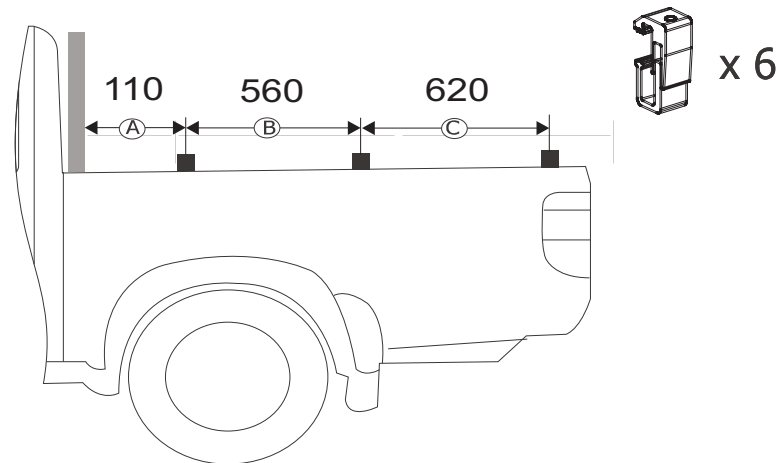

3.4

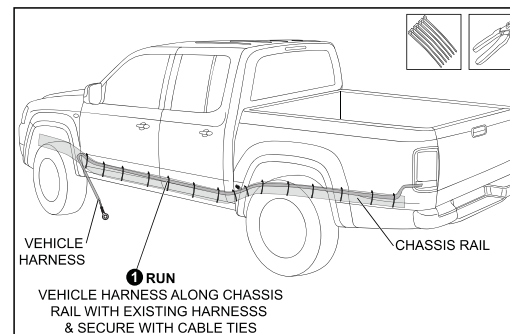

Diagram: 4 - RUN HARNESS ALONG CHASSIS RAIL

Run the vehicle harness along the chassis rail with existing wiring, up to the front left hand wheel arch as shown. Fit cable ties to secure the vehicle harness to the existing harness every 300-400mm. Trim excess cable tie length with side cutters. Ensure harness is run in a direct route from the rear of the vehicle to the front. (ref. diagram 4).

3.5

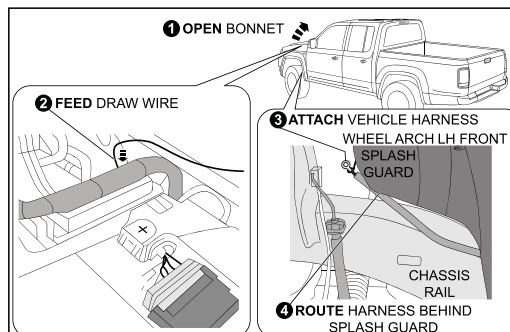

Diagram: 5 - USING A DRAW WIRE PULL HARNESS INTO ENGINE BAY

Open and secure the bonnet. Feed a draw wire down through the engine bay in the rear left hand corner where the inner left hand front quarter panel meets the firewall as shown. From inside the left hand front wheel arch, attach the end of the vehicle harness to the draw wire. Using two (2) people, one person feeding the vehicle harness and the second person to pull the draw wire until the harness is at the top of the engine bay. Ensure harness is positioned behind the splash guard inside the wheel arch as shown. Remove the draw wire. (ref. diagram 5). **IMPORTANT:** The wiring must be positioned against the firewall and avoid contact against any pipes or other wiring under tension of canopy vehicle wiring harness

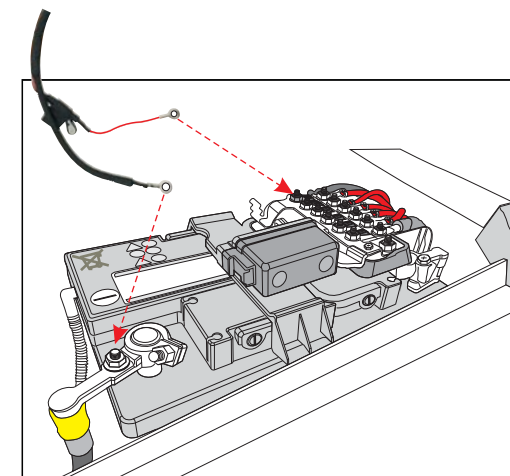

Diagram: 6 - CONNECT VEHICLE HARNESS TO TERMINAL

Fit the vehicle harness terminal into the Battery terminal block as shown. (ref. diagram 6).

3.6

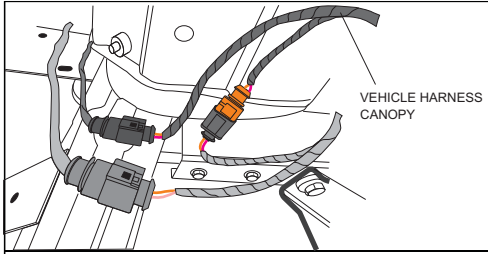
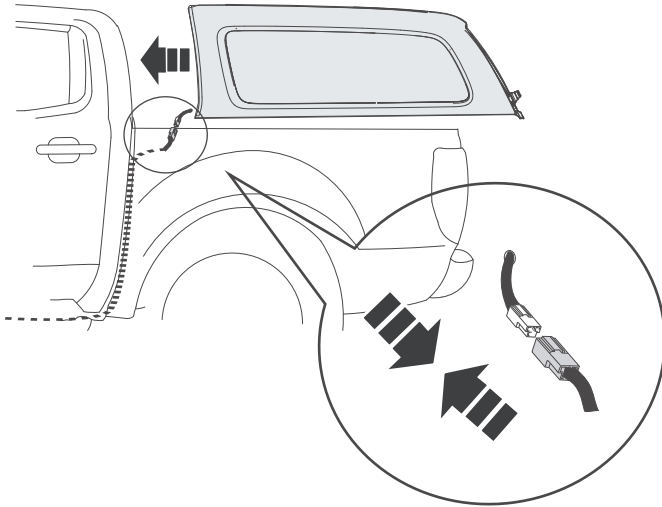

Diagram: 7 - FIT VEHICLE HARNESS CANOPY

Disconnect the fuel flap connector behind the left rear wheel arch. Connect Y-adapter on the canopy harness and fuel flap wiring of the vehicle. Fit with cable ties securely (ref. diagram 7).

3.7



3.8

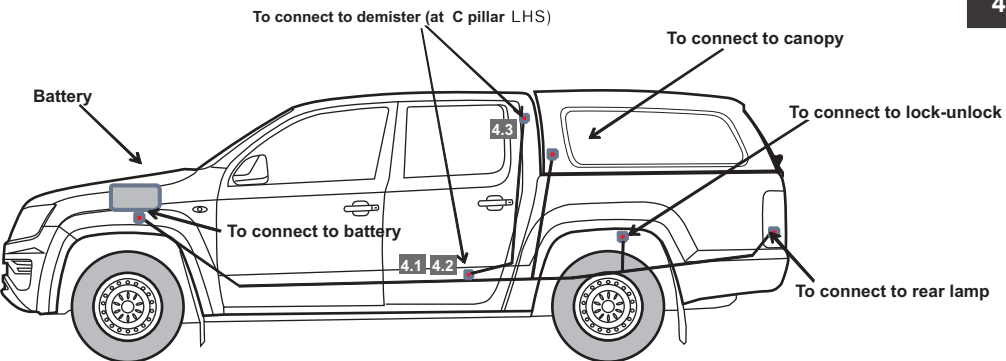

4

To connect to demister (at C pillar LHS)

To connect to canopy

To connect to lock-unlock

To connect to rear lamp

Battery

To connect to battery

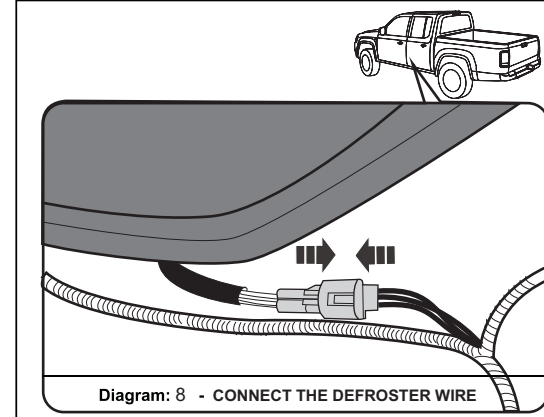

Diagram: 8 - CONNECT THE DEFROSTER WIRE

4.1

Connect the defroster wire to the main wiring under the left rear door. (ref. diagram 8).

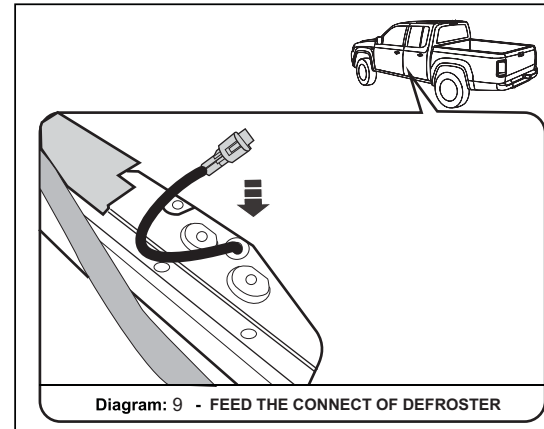

Diagram: 9 - FEED THE CONNECT OF DEFROSTER

4.2

Feed the connector of defroster cable out of cabin through the original hole under the left rear plastic step. (ref. diagram 9).

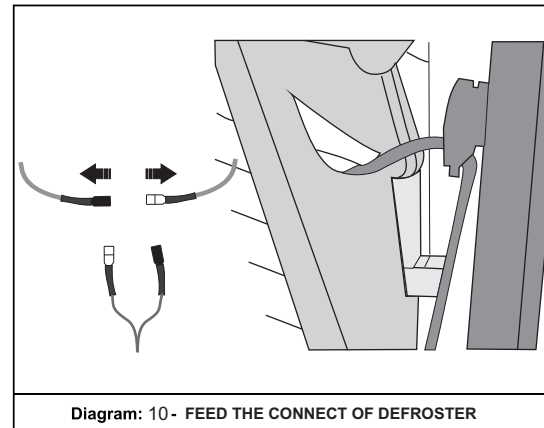

Diagram: 10 - FEED THE CONNECT OF DEFROSTER

4.3

Connect the Y-adapter of defroster wire to the original defroster connector on the rear window. (ref. diagram 10).